



Laundering and Care

The straps, liners & pads can be removed and hand washed in cold or lukewarm water with mild soap or detergent and air dried.

Warning

1. Carefully read this application instruction and warning prior to fitting braces, failure to properly position the brace and fasten each strap will compromise performance and support.
2. This support should not impair circulation.
3. Federal Law restricts the sale of this Device to anyone other than a Licensed Health Care Provider.
4. Settings of Flexion/Extension controls should be undertaken by medical professionals only

Caution

1. Single patient use only
2. Do not over-tighten closures
3. If irritation, pain or discomfort occurs while wearing this brace, discontinue use and immediately consult your medical professional.

EUROPEAN AUTHORIZED REPRESENTATIVE



Wellkang Ltd
Suite B, 29 Harley Street,
LONDON, W1G 9QR, U.K.
www.CE-Marking.EU



Council Directive
93/42/EEC of
14 June 1993
concerning Medical Device

MANUFACTURED BY

Dicarre LLC

info@dicarre.com

Toll Free-1-844-DICARRE

125 Half Mile Road, Suite 200
Red Bank, NJ 07701

www.dicarre.com

Thor **DICARRE**
Post-Op Knee Brace
DK49
User Guide
Application Instruction

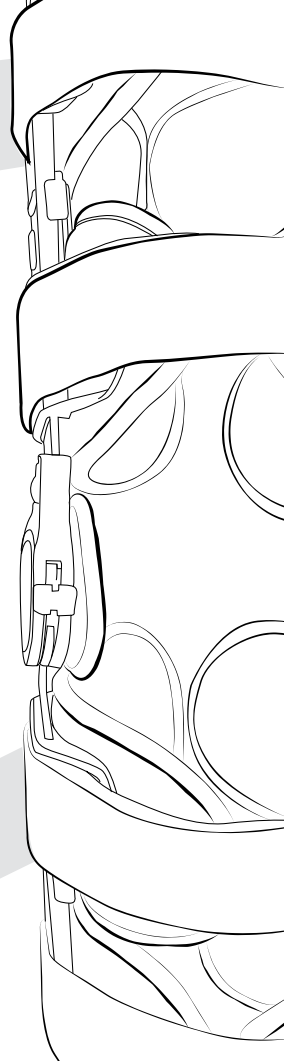

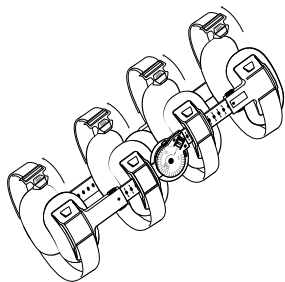

1. Release All Four Buckles

- Grip The Shoulder On Buckle To Release It.
- Place the brace beside the leg to determine the proper length, aligning the hinge with the centre of the knee.

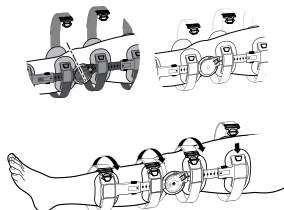

3. Apply Brace

With the leg extended, slide the brace underneath the leg with closure at the front. Make sure the center of the hinge is aligned with the center of the knee. Align the arms of the brace along the middle of leg. The hinges should be even and parallel with the knee joint. Attach gastic strap. Wrap around and pull through D-ring then attach the double sided hook, alligator velcro and trim off excess strap.

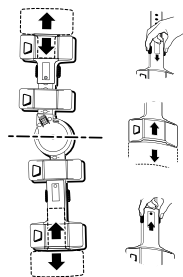

2. Adjust Tibial and Femur Length

- Slide the locking tab up to free the adjustment button.
- Slide extension arms to desired length and slide locking tab back in place to lock extension arm.

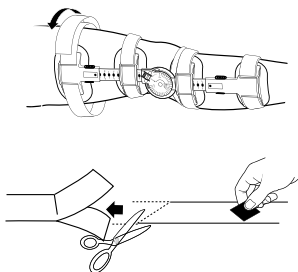

4. Secure Straps

On arm opposite the buckle, pull anterior strap away from leg disengaging hook allowing strap movement. Reattach over buckles and remove small piece of hook from strap end. Pull strap to desired tension Reattach hook end to secure strap and trim off excess length. Repeat process for remaining straps.

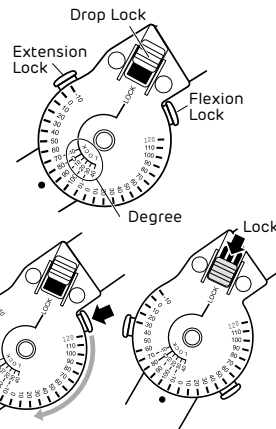

5. Set Rang-of-Motion

Pull extension ROM button and slide to desired setting.

Pull flexion ROM button and slide to desired setting.

Adjust opposite to the same setting of first hinge.

CAUTION: The ROM stops on both the medial and lateral must be the same.

6. Lock Hinge

Lock hinge at a desired -10, 0, 10, 20, 30, or 40 degrees. Bend leg to desired setting and engage lock on each hinge. This will lock the brace in place independent of ROM setting. Make sure ROM setting do not interfere with desired lock setting.

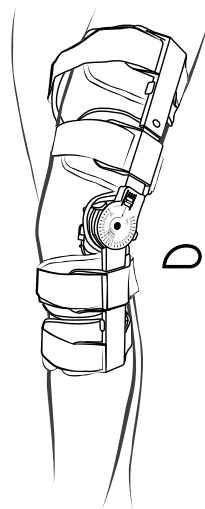

DICARRE | Thor Post-Op Knee Brace